

Applications

Make	Model	Year	Variants
Fiat	500	2007-2016	Easy Power LPG LPG Bi-Fuel LPG 8V ECO Natural Power Dualogic Bipower CNG
	Grande Punto	2005-2012	
	Patio	2000-2006	
	Panda	2003-2016	
	Punto	1999-2015	
	Doblo	2005-2010	
	Fiorino	2009-2016	
	Idea	2005-2012	
	Linea	2007-2011	
	Qubo	2009-2016	
	Strada Pick-up	2000-2006	
Lancia	Musa	2005-2013	
	Ypsilon	2000-2016	
Alfa Romeo	MiTo	2010-2016	
Chrysler	Ypsilon	2011-2015	

Engine Code

1.2	169A4.000, 199A4.000, 350A1.000, 188A4.000
-----	--

Our products are designed to be used correctly and with care for the purpose for which they are intended. No liability is accepted by Sonic for incorrect use of any of our products, and Sonic cannot be held responsible for any damage to personnel, property or equipment when using the tools. Incorrect use will also invalidate the warranty.

If applicable, the applications database and any instructional information provided has been designed to offer general guidance for a particular tool's use and while all attention is given to the accuracy of the data no project should be attempted without referring first to the manufacturer's technical documentation (workshop or instruction manual) or the use of a recognised authority such as Autodata.

It is our policy to continually improve our products and thus we reserve the right to alter specifications and components without prior notice. It is the responsibility of the user to ensure the suitability of the tools and information prior to their use.



Instructions

Engine Timing Kit
Fiat, Ford Petrol - 1.2 8v



829024 - Engine Timing Kit

Description:

The 829024 is an engine locking kit designed for the Fiat 1.2 petrol engines.

Components

Ref	Comp	OEM	Description
1	4880184	1 860 987 000	Tension Wrench
2	4880007	2 000 004 400, 2 190 754 400	Camshaft Alignment Strap
3	4880008	2 000 004 200, 2 190 754 200	Camshaft Sprocket Locking Tool
4	4880009	2 000 004 300	Camshaft Cover Alignment Tool
5	4880006	2 000 004 500, 2 190 754 500	Crankshaft Alignment Tool
6			Skt Hd Cap screw M10 x 20
7			Washers M6 Form x5
8			M6 Set Screw 30mm Long Zinc x5
9			M8 x 20 H.T. Setscrew x3

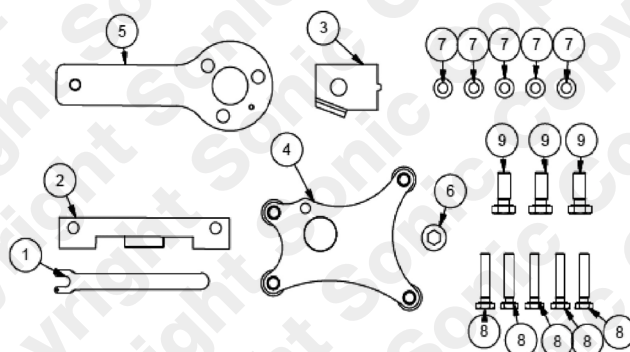

Instructions

The following instructions are for guidance only. Please refer to OEM derived data such as the vehicles manufactures own data or Autodata. The use of these engine timing tools is purely down to the user's discretion and Sonic cannot be held responsible for any damage caused what so ever.

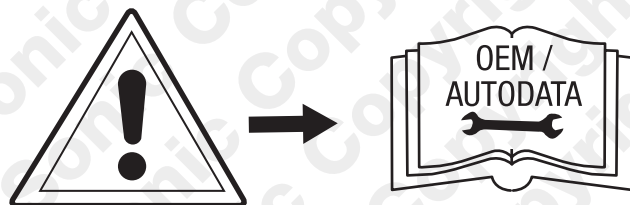

Instructions

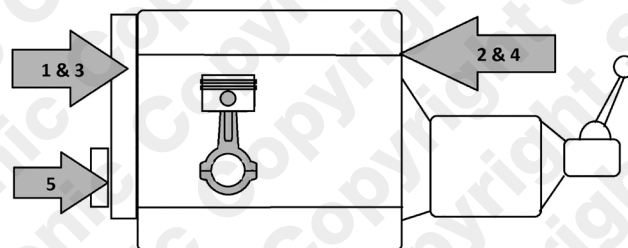

Component 1 - Tension Wrench

Used to adjust the camshaft drive belt tension by turning the tensioner.

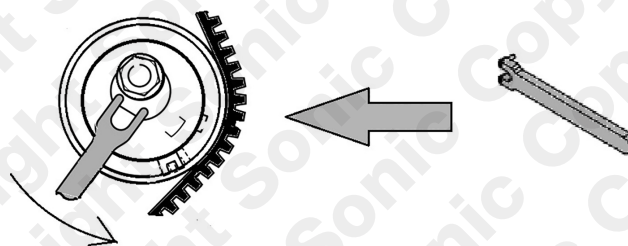

Component 2 - Camshaft Alignment Strap (SOHC)

Component 2 is used to lock the camshaft in its timed position. Fits from the gear box end of the camshaft with cam cover removed.

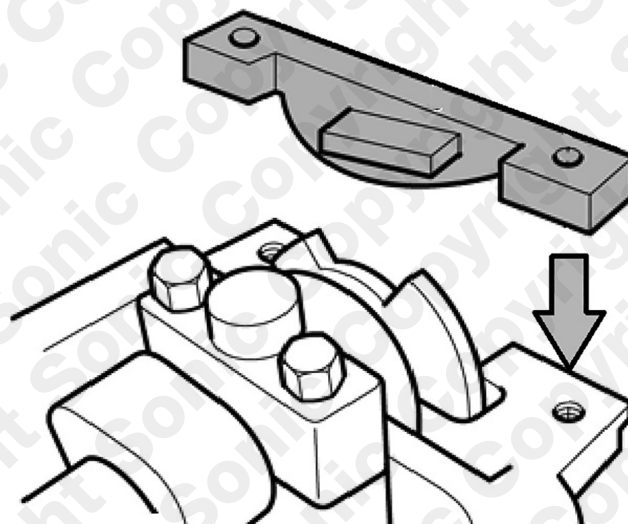

Component 3 - Camshaft Sprocket Locking Tool

Component 3 is used to lock and hold the camshaft pulley so the pulley fixing can be loosened or tightened (VVT engines only).

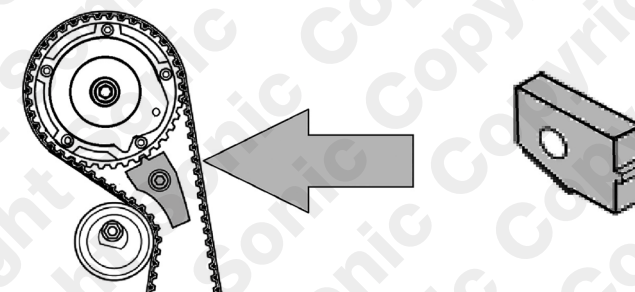

Component 4 - Camshaft Cover Alignment Tool

Component 4 is used to correctly align the cam cover when refitting after setting the timing.

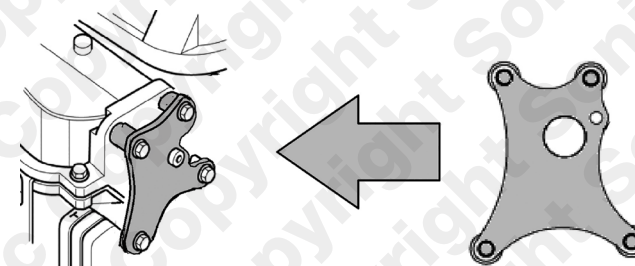

Component 5 - Crankshaft Alignment Tool

Use component 5 to lock the crankshaft in its timed position once the crankshaft pulley has been removed.

